



### Please Note:

To ensure both current and historical interchange system information is available to all who utilize the Interchange Drawing Viewer, some of the Interchange Drawing PDF files will display with hand-sketched updates. New hand-sketched files will be added when updated information is received through construction and maintenance channels. New CAD drawings will be added as they are completed. There is currently a five-year backlog on updating the CAD drawings.

If you have questions about updates to the Interchange Drawing, the hand-sketched versions of the drawings, or the Interchange Viewer Web App please email [TransportationGISDataSteward@WSDOT.WA.GOV](mailto:TransportationGISDataSteward@WSDOT.WA.GOV) with Interchange Drawing Feedback or Inquiry in the subject line.

**Continue to the following pages to see the current and historical interchange configurations.**

### *Did you know...?*

- You can download the PDF file to your computer.
- Once downloaded, you can access the layers that compose each drawing through Adobe Acrobat Reader or Pro. NOTE: Layers are not available on hand-sketches.
- [How to download and view Interchange Drawing layers in Adobe Acrobat \(PDF 115KB\)](#)

Effective Date:  
10/13/20

Low

10-13-2020

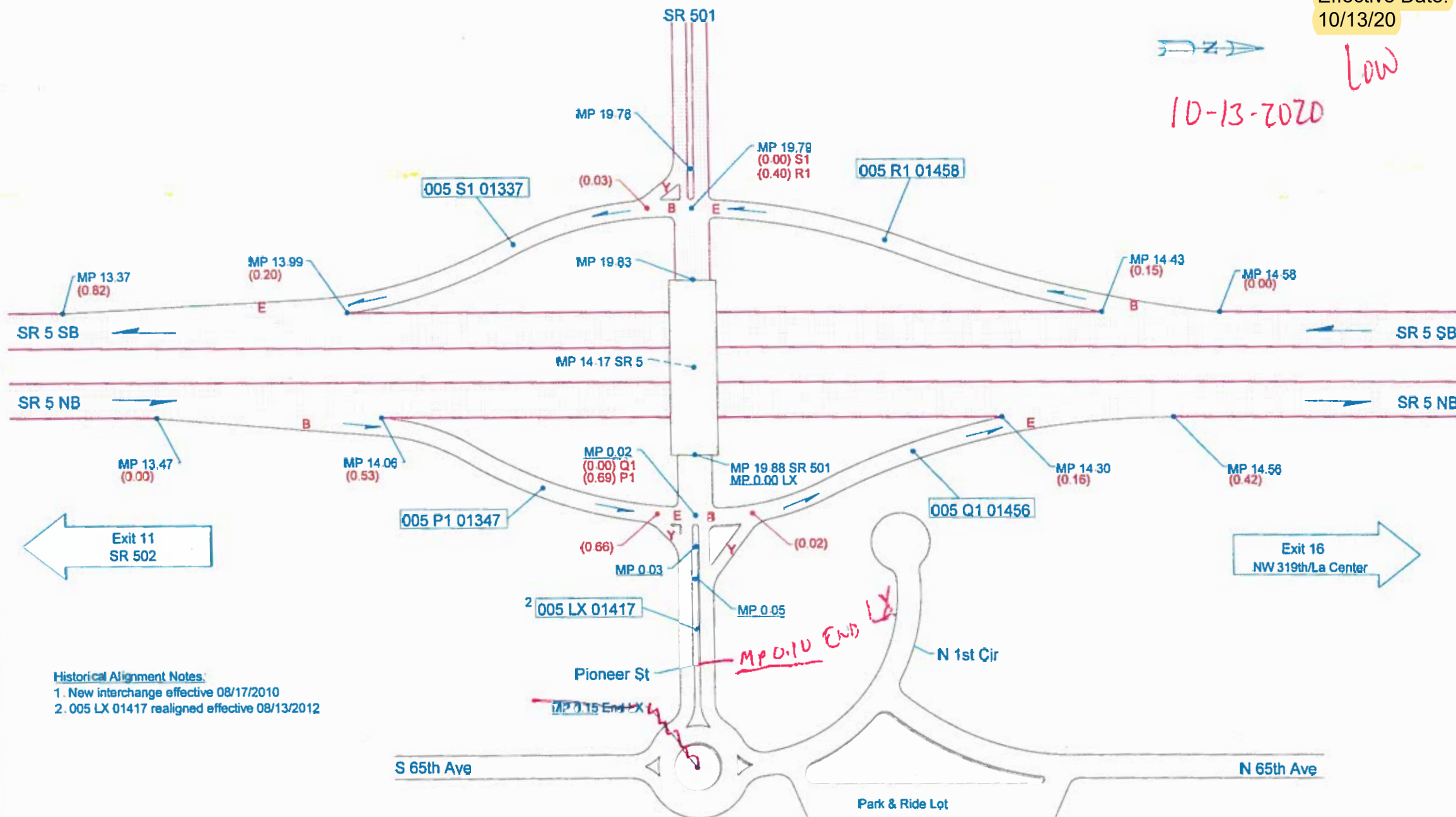

Historical Alignment Notes:

1. New interchange effective 08/17/2010
2. 005 LX 01417 realigned effective 08/13/2012

Not To Scale

03/25/2013 KWP

WSDOT SOUTHWEST REGION

RIDGEFIELD, CLARK COUNTY

JUNCTION SR 501/PIONEER ST

SR 5 - EXIT 14

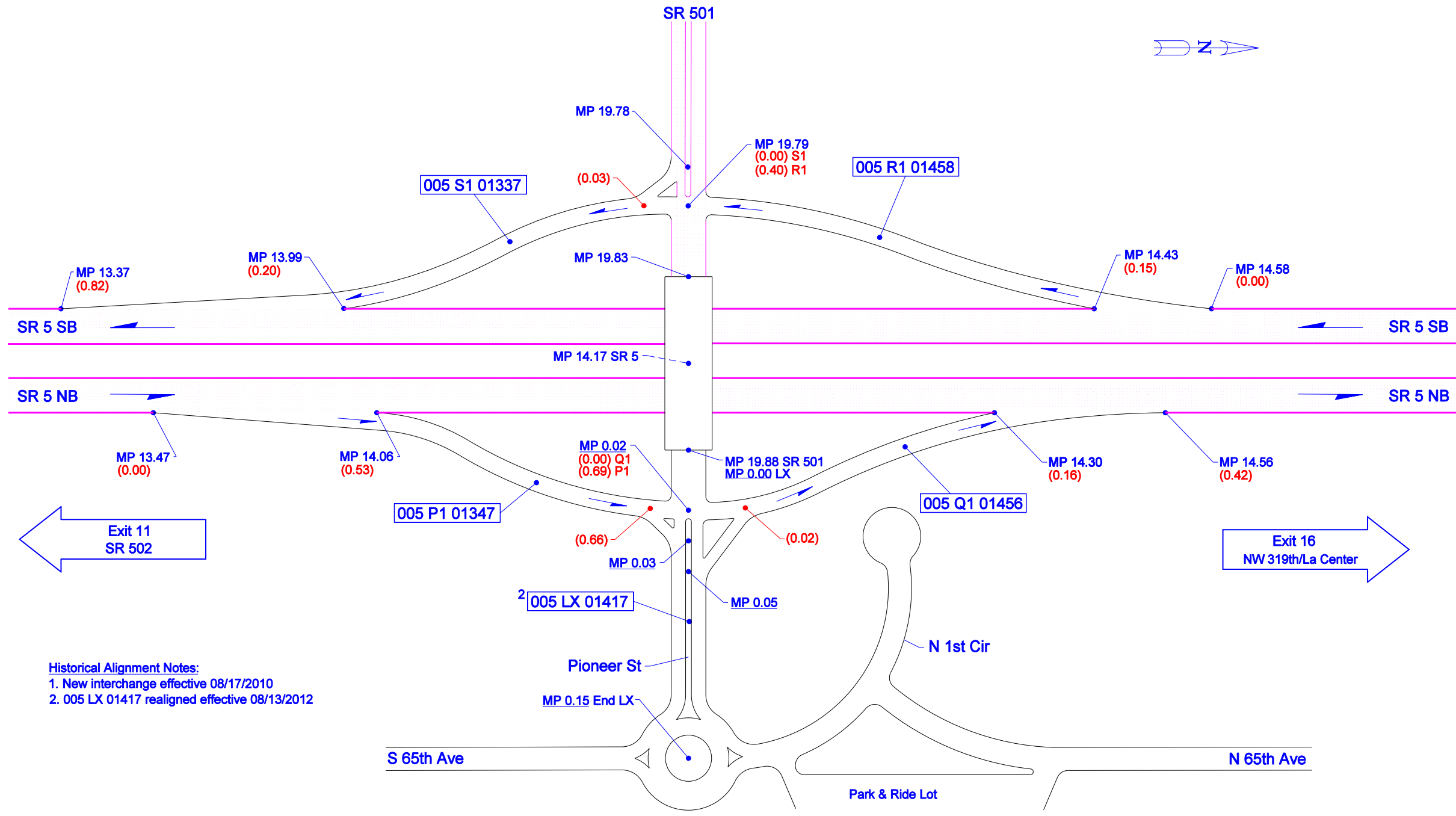

Historical Alignment Notes:  
1. New interchange effective 08/17/2010  
2. 005 LX 01417 realigned effective 08/13/2012