

**PERSPECTIVE VIEW
TRUSS STRUCTURE**

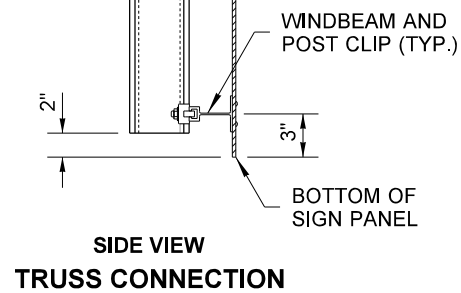

NOTES

1. U-Bolts, Washers and Nuts shall be stainless steel, except as noted.
2. See **Standard Plan G-90.10** for Sign Bracing and Mounting details. For Sign Bridge Structure parts, see **Standard Specification Section 9-28.14(2)**.
3. Galvanize all non-stainless steel parts. See **Standard Specification Section 9-28.14(2)** for requirements.
4. For VMS mounting, the contractor may substitute W6 x 12 Steel or W8 x 13 Steel sections for the Vertical Brace W4 x 13 Steel.
5. 3' - 0" MAX. Vertical Brace spacing for Walk-In Cabinet Type VMS installation.
6. All locknuts shall conform to **Standard Specification Section 9-28.11** as supplemented in the Special Provisions.
7. For all sign lighting bracing details not shown, See **Standard Plan G-90.11**.



**OVERHEAD SIGN MOUNTING
(TRUSS STRUCTURE)**

STANDARD PLAN G-90.30-04

SHEET 1 OF 1 SHEET

APPROVED FOR PUBLICATION