

DRAWN BY: FERN LIDDELL

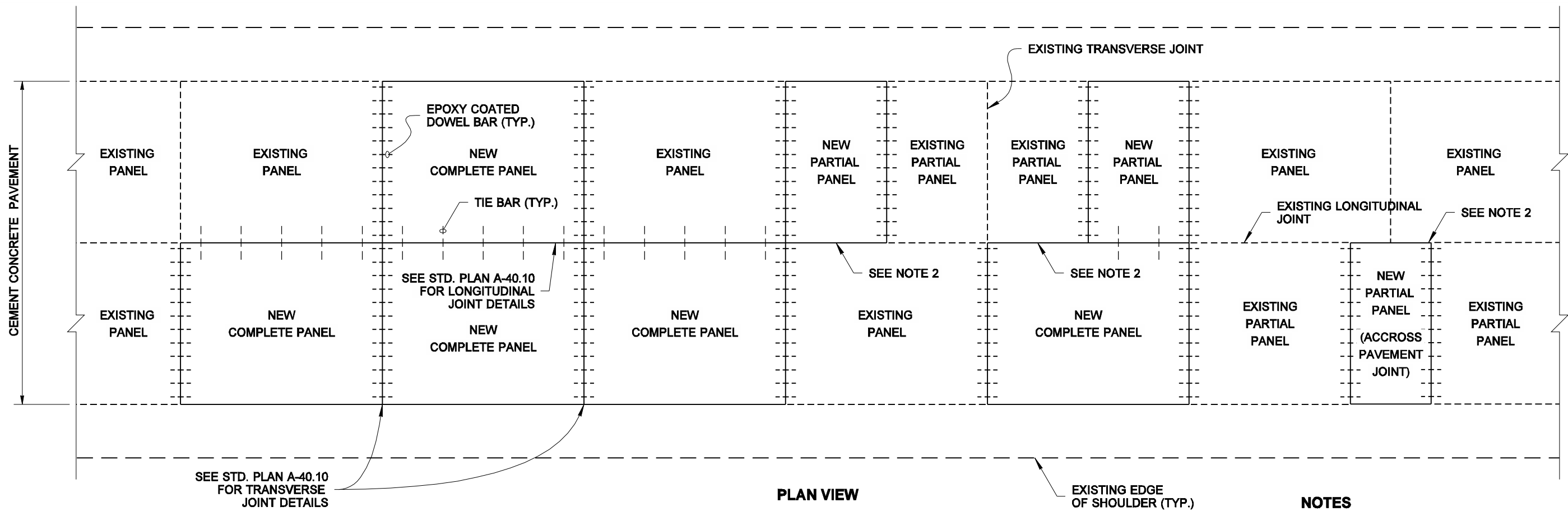

**PLAN VIEW  
PANEL REPLACEMENT**

**NOTES**

1. Install tie bars along longitudinal joint between full panel replacement and existing cement concrete pavement. Tie bars are not installed between cement concrete pavement and hot mix asphalt shoulders.
2. Place polyethylene film (per AASHTO M 171) or building paper along the longitudinal joint between partial panel replacement and existing panel.

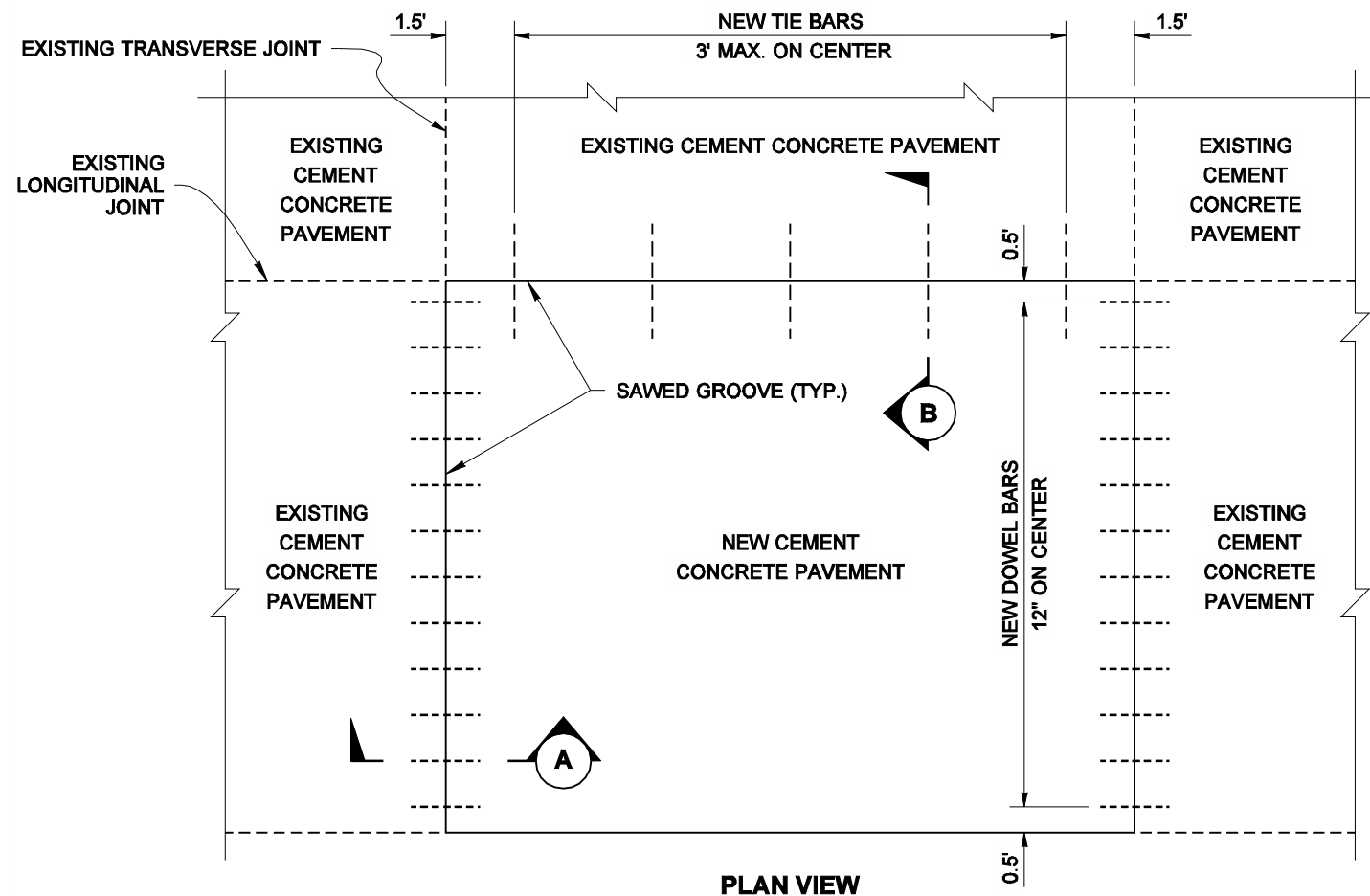

**PLAN VIEW  
COMPLETE PANEL REPLACEMENT DETAIL**

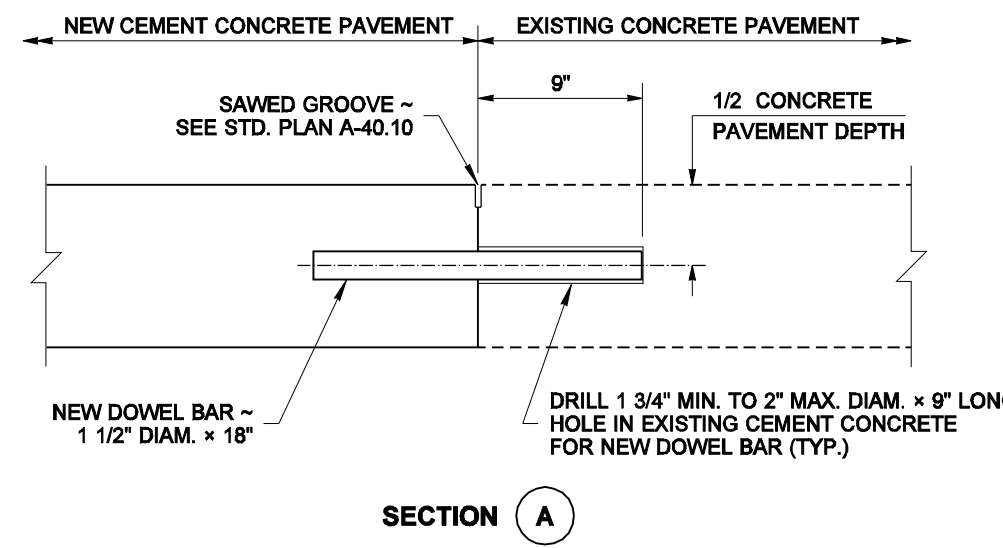

**SECTION A**



EXPIRES MAY 5, 2008

NOTE: THIS PLAN IS NOT A LEGAL ENGINEERING DOCUMENT BUT AN ELECTRONIC DUPLICATE. THE ORIGINAL, SIGNED BY THE ENGINEER AND APPROVED FOR PUBLICATION, IS KEPT ON FILE AT THE WASHINGTON STATE DEPARTMENT OF TRANSPORTATION. A COPY MAY BE OBTAINED UPON REQUEST.

**CEMENT CONCRETE  
PAVEMENT REPAIR  
STANDARD PLAN A-60.10-00**

SHEET 1 OF 2 SHEETS

APPROVED FOR PUBLICATION

**Pasco Bakotich III** 10-05-07

STATE DESIGN ENGINEER

DATE



Washington State Department of Transportation

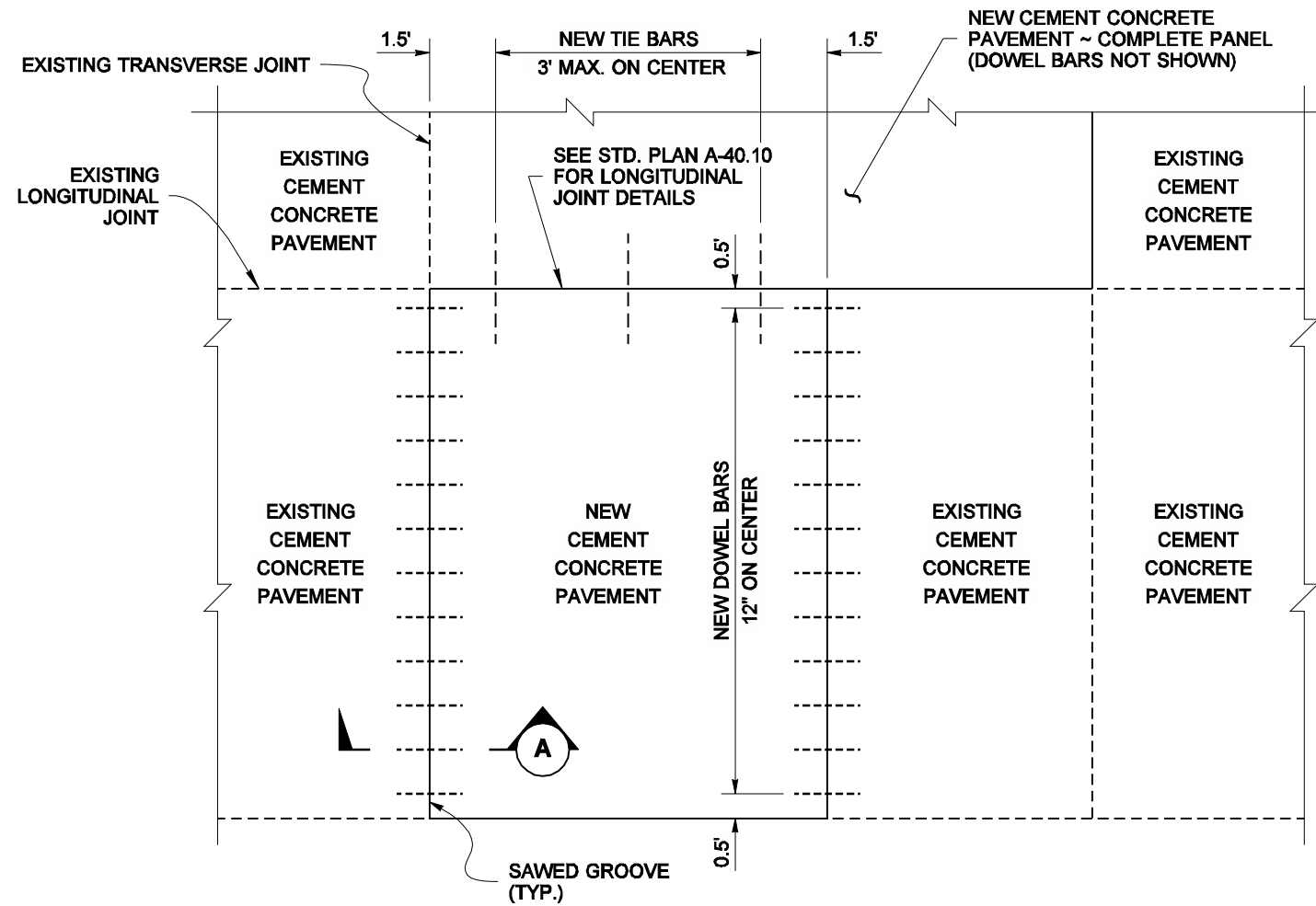

**PLAN VIEW**  
**PARTIAL PANEL REPLACEMENT**  
**WITH TIE BARS**

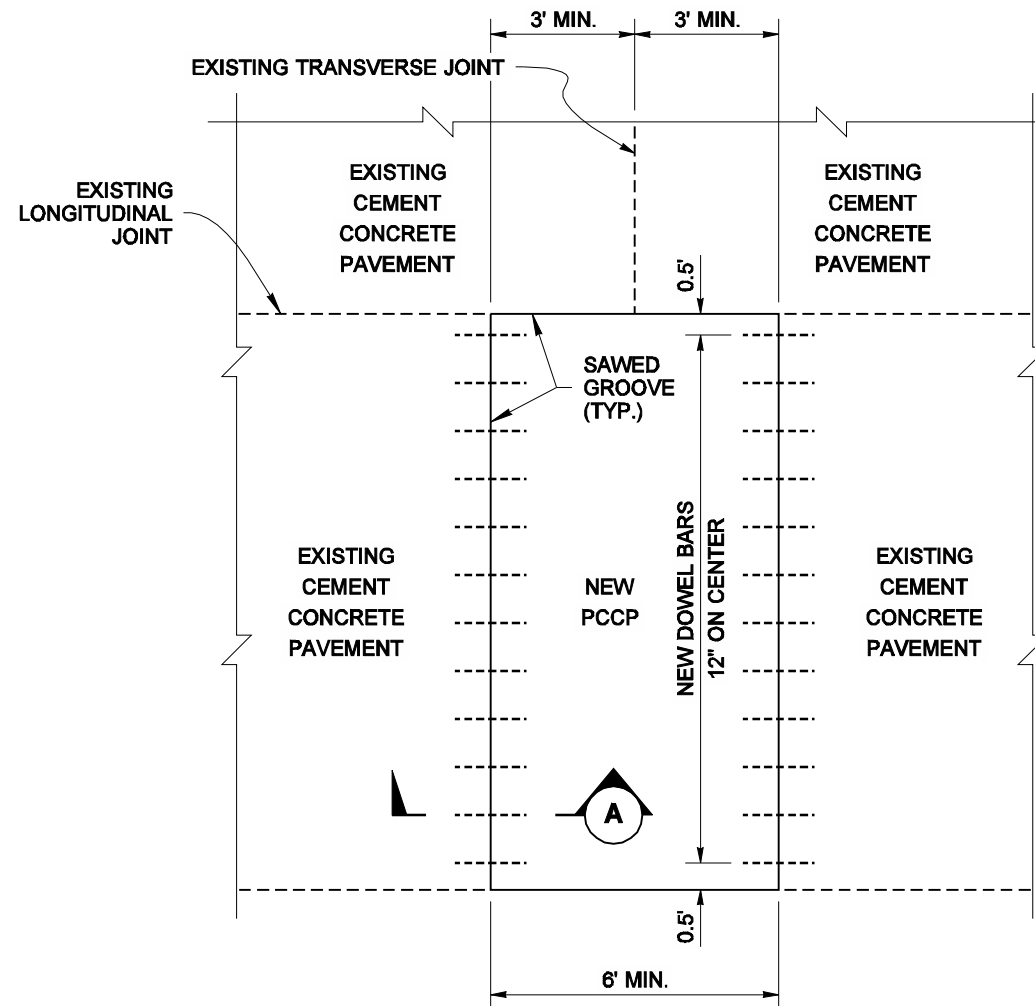

**PLAN VIEW**  
**PARTIAL PANEL REPLACEMENT**  
**WITHOUT TIE BARS**

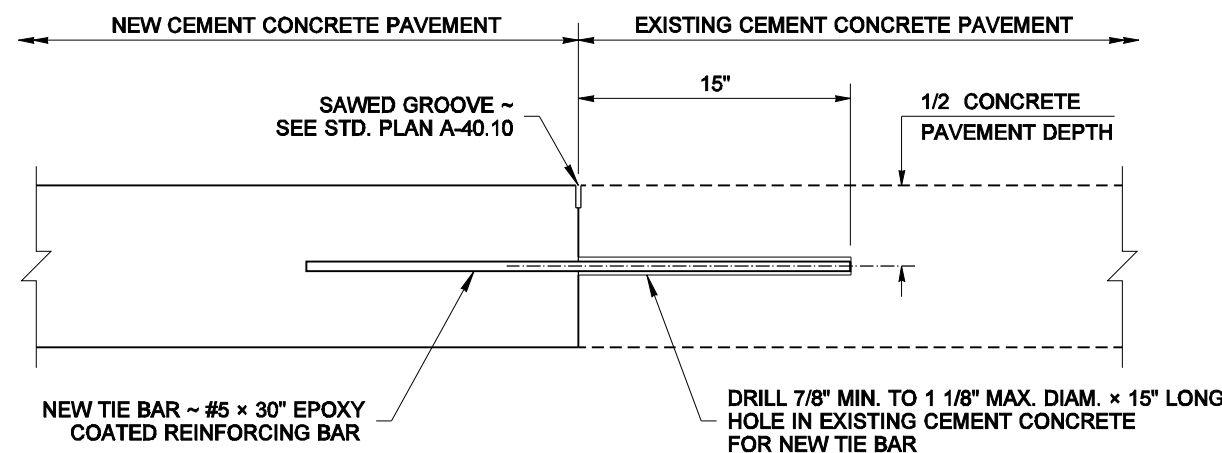

**SECTION B**



EXPIRES MAY 5, 2008

NOTE: THIS PLAN IS NOT A LEGAL ENGINEERING DOCUMENT BUT AN ELECTRONIC DIVULGATE. THE ORIGINAL, SIGNED BY THE ENGINEER AND APPROVED FOR PUBLICATION, IS KEPT ON FILE AT THE WASHINGTON STATE DEPARTMENT OF TRANSPORTATION. A COPY MAY BE OBTAINED UPON REQUEST.

**CEMENT CONCRETE PAVEMENT REPAIR**  
**STANDARD PLAN A-60.10-00**

SHEET 2 OF 2 SHEETS

APPROVED FOR PUBLICATION

**Pasco Bakotich III** 10-05-07  
 STATE DESIGN ENGINEER DATE

