

IDENTIFICATION PLATE DETAIL
(SEE NOTE 5)

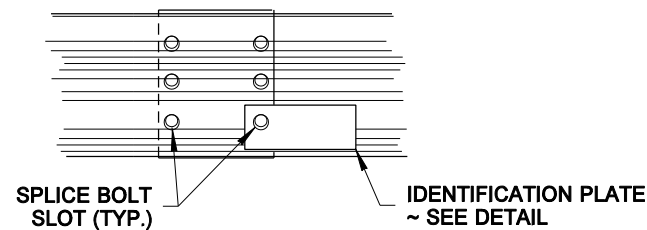

IDENTIFICATION PLATE MOUNTING DETAIL
(SEE NOTE 6)

NOTES

1. See Contract for transition and connection type.
2. For additional installation requirements for Non-Flared Terminal placement see **Standard Plan C-22.40**.
3. Guardrail installation shall be Beam Guardrail Type 31 with standard post and block.
4. The first letter of case designation indicates the end treatment on the side road. The second letter indicates the end treatment on the main road. For instance, a terminal on a side road and a bridge connection on the main road would be Case 22BC-31.
5. The radius dimension shall be etched into the plate as shown in the example on the Identification Plate Detail. Numerals shall be 1 1/2" high minimum, and 3/4" wide maximum. Plate shall be galvanized after etching.
6. The guardrail Identification Plate shall be mounted at the lower splice bolt on the back side of the rail element at the PC of the guardrail radius.



NOTE: THIS PLAN IS NOT A LEGAL ENGINEERING DOCUMENT
NOTE: ELEMENTS OF THIS PLAN, INCLUDING BUT NOT LIMITED TO THE ENGINEERING DESIGN, SPECIFICATIONS, AND CALCULATIONS, SHALL BE FILED AT THE WASHINGTON STATE DEPARTMENT OF TRANSPORTATION. A COPY MAY BE OBTAINED UPON REQUEST.

**GUARDRAIL PLACEMENT
STRONG POST ~ TYPE 31
INTERSECTION DESIGN
STANDARD PLAN C-20.42-01**

SHEET 1 OF 1 SHEET

APPROVED FOR PUBLICATION

Pasco Bakotich III 10-14-09
STATE DESIGN ENGINEER DATE

