

DRAWN BY: FERN LIDDELL

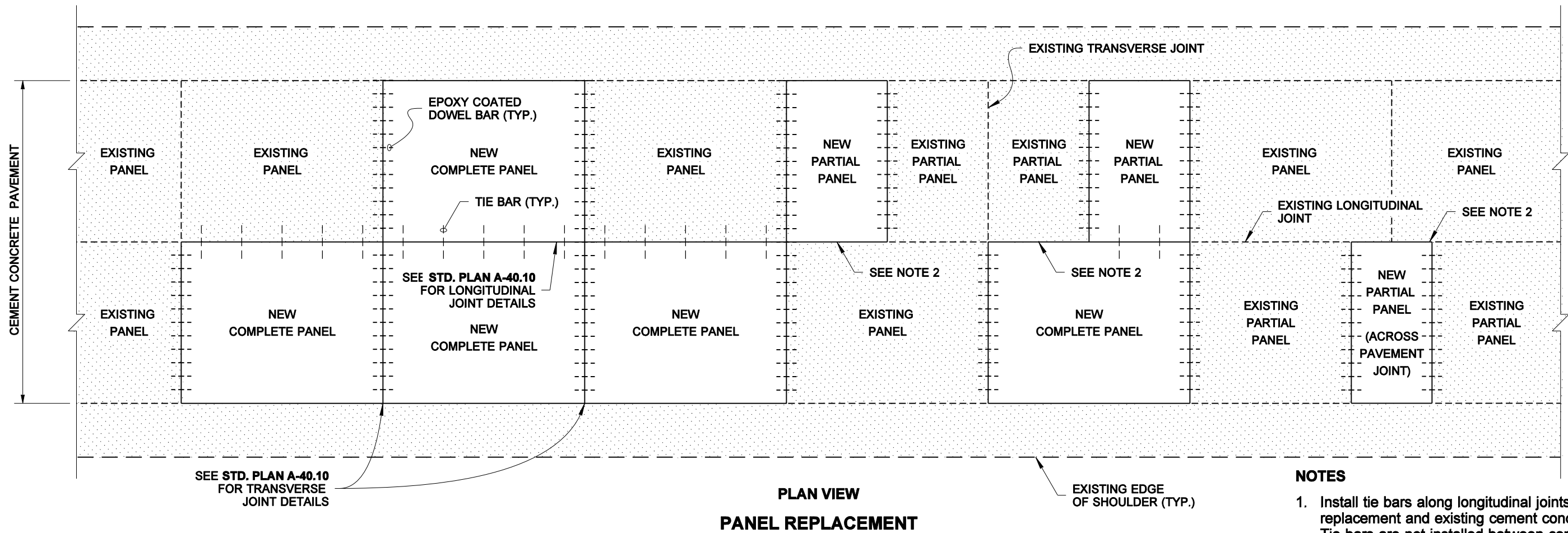

**PLAN VIEW  
PANEL REPLACEMENT**

**NOTES**

1. Install tie bars along longitudinal joints between full panel replacement and existing cement concrete pavement. Tie bars are not installed between cement concrete pavement and hot mix asphalt shoulders.
2. Place polyethylene film (per AASHTO M171) or building paper along the longitudinal joint between partial panel replacement and existing panel.
3. Place new dowel bars between existing dowel bars. Don't place any dowel bars closer than 1' - 0" from edge of concrete panel.

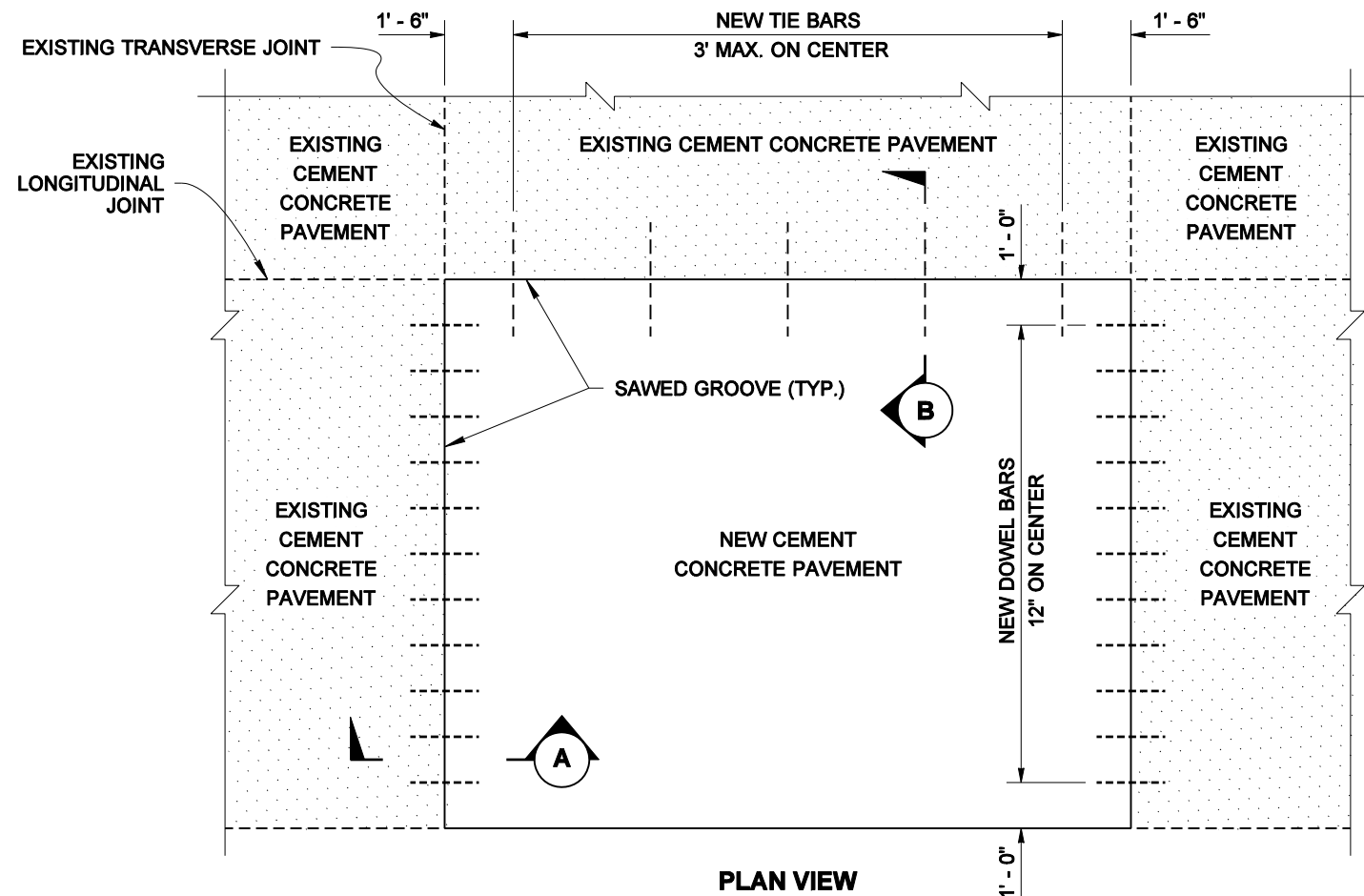

**PLAN VIEW  
COMPLETE PANEL REPLACEMENT DETAIL**

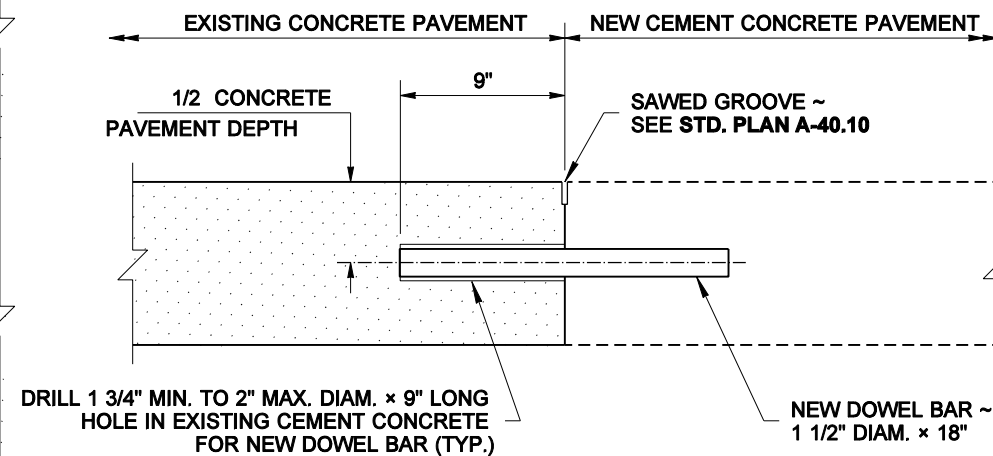

**SECTION A**

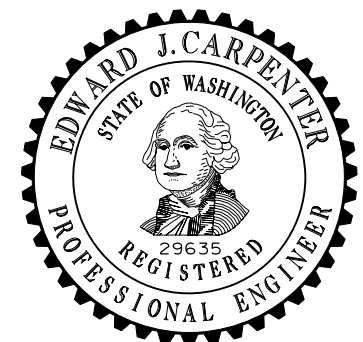

NOTE: THIS PLAN IS NOT A LEGAL ENGINEERING DOCUMENT UNTIL IT IS APPROVED AND SEALED BY THE ENGINEER. THE ENGINEER'S APPROVAL IS VALID ONLY IF THE ENGINEER HAS FILED THIS PLAN WITH THE WASHINGTON STATE DEPARTMENT OF TRANSPORTATION. A COPY MAY BE OBTAINED UPON REQUEST.

**CEMENT CONCRETE PAVEMENT REPAIR  
STANDARD PLAN A-60.10-01**

SHEET 1 OF 2 SHEETS

APPROVED FOR PUBLICATION

**Pasco Bakotich III** 10-14-09  
STATE DESIGN ENGINEER DATE



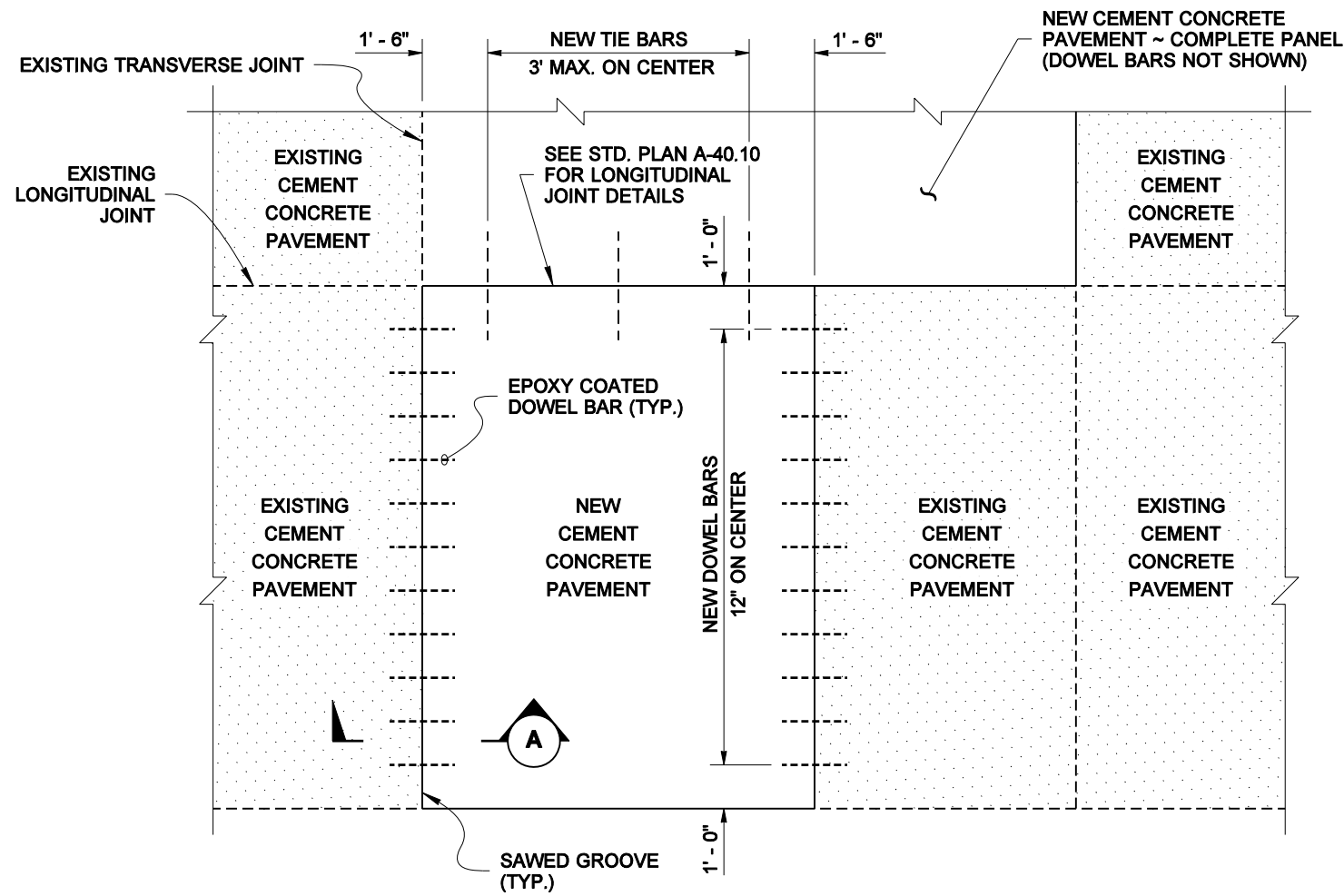

**PLAN VIEW**  
**PARTIAL PANEL REPLACEMENT**  
**WITH TIE BARS**

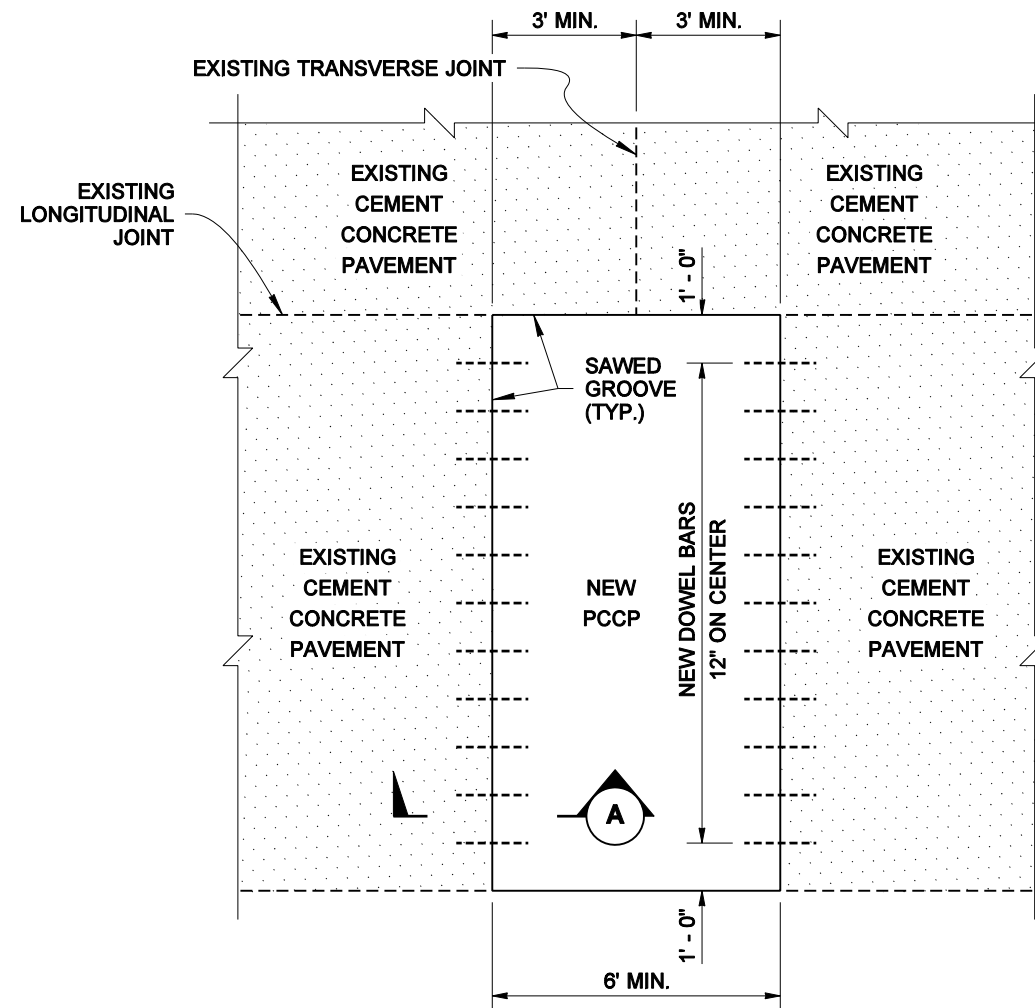

**PLAN VIEW**  
**PARTIAL PANEL REPLACEMENT**  
**WITHOUT TIE BARS**

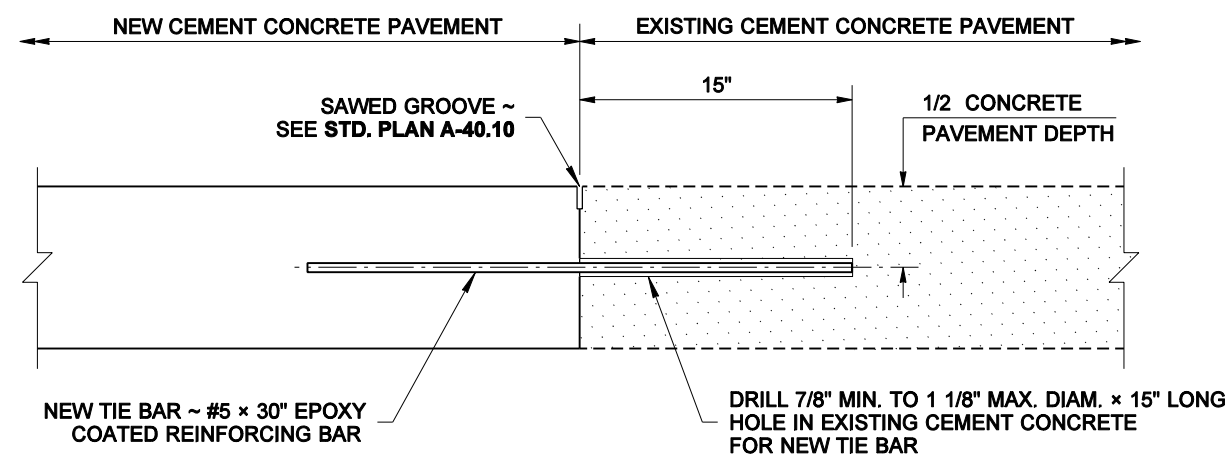

**SECTION B**



NOTE: THIS PLAN IS NOT A LEGAL ENGINEERING DOCUMENT  
 FOR CONSTRUCTION. IT IS THE RESPONSIBILITY OF THE ENGINEER TO OBTAIN ALL NECESSARY PERMITS AND APPROVALS FROM THE WASHINGTON STATE DEPARTMENT OF TRANSPORTATION. A COPY MAY BE OBTAINED UPON REQUEST.

**CEMENT CONCRETE PAVEMENT REPAIR**  
**STANDARD PLAN A-60.10-01**

SHEET 2 OF 2 SHEETS  
 APPROVED FOR PUBLICATION  
**Pasco Bakotich III** 10-14-09  
 STATE DESIGN ENGINEER DATE  
 Washington State Department of Transportation