



March 25, 2011

Washington State Department of Fish and Wildlife  
 Habitat Program  
 600 N. Capitol Way  
 Olympia, WA 98501-1091

RE: SR 18 Maple Valley to Issaquah-Hobart Road (MP 16.6 to 19.3) (Taylor Creek Crossing 4)  
 WDFW HPA Permit **00000F4792-14**

Dear Interested Parties:

The Washington State Department of Transportation completed monitoring of the site on August 10 and September 16, 2010 to determine compliance with the above-listed HPA.

General Site Information	
<b>WDFW HPA Permit Number</b>	00000F4792-14
<b>Restoration Location</b>	SR 18 East, Exit 142, along Taylor Creek, near Maple Valley in King County.
<b>LLID Number</b>	1219981474226
<b>Construction Date</b>	2006-2007
<b>Monitoring Period</b>	2007-2016
<b>Year of Monitoring</b>	4 of 10
<b>Type of Restoration</b>	Riparian re-vegetation

**Site development:**

Permit Requirement	2010 Results	Management Activities
80% or greater survival of planted woody species for ten years	85%	Weed control occurred in May 2010

Based on data collected in 2009 and visual estimates made in 2010, survival of planted woody species is estimated to be 85 percent.

Because survival of planted woody species becomes less relevant and more difficult to measure reliably after three years, monitoring efforts were shifted to estimating woody cover on this site. The plantings on site are doing extremely well and native woody cover is estimated at 85 percent. The dominant species are redosier dogwood (*Cornus sericea*), Pacific ninebark (*Physocarpus capitatus*), twinberry honeysuckle (*Lonicera involucrata*), and salmonberry (*Rubus spectabilis*).

No signs of bank erosion were observed.

We welcome your questions or comments. Please contact me at 360/570-6640 or by e-mail at [busht@wsdot.wa.gov](mailto:busht@wsdot.wa.gov) for questions about these mitigation sites.

Sincerely,

Tony Bush  
Wetland Assessment and Monitoring Program

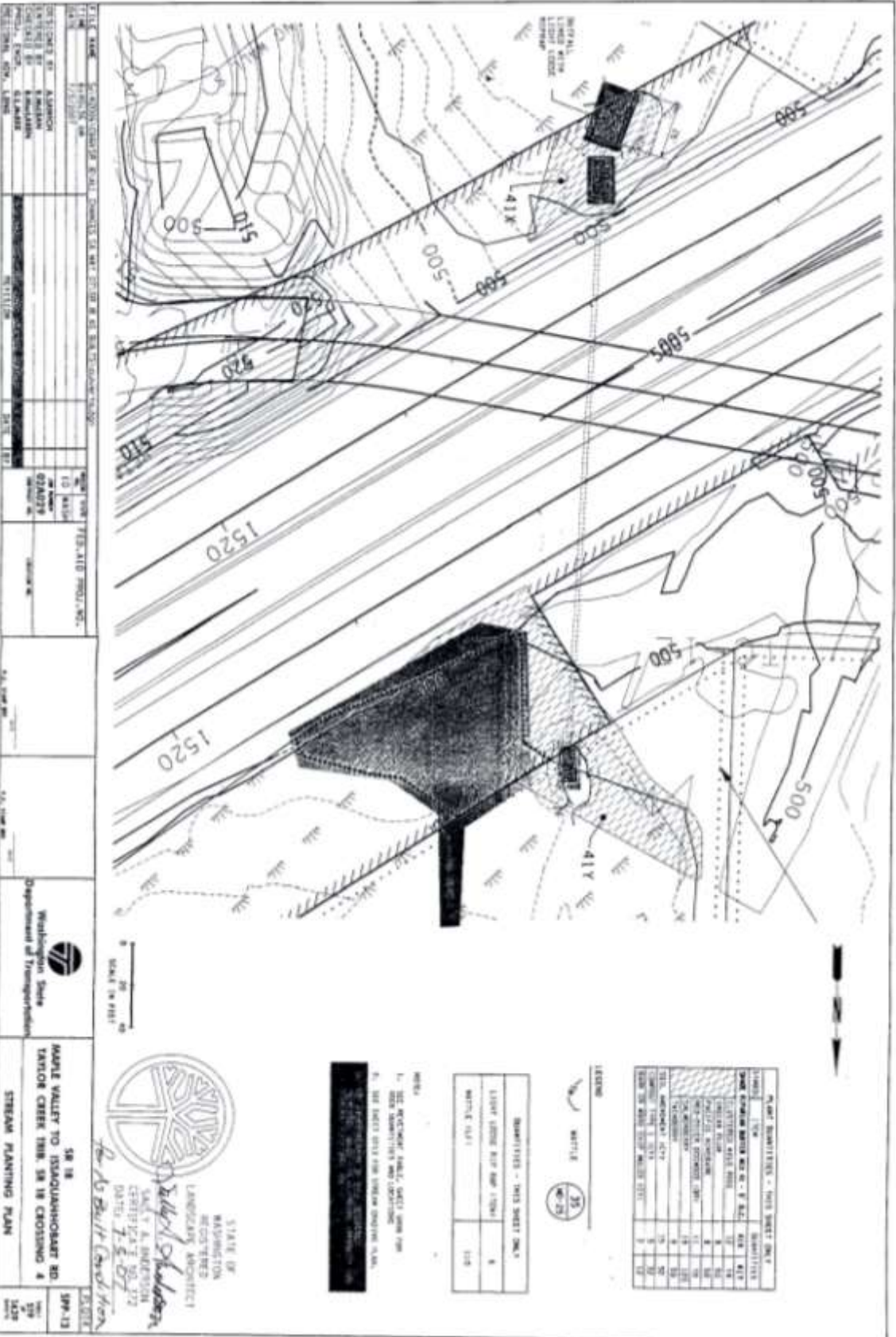

PERMITS - THIS SHEET ONLY

NO.	TYPE	DATE	ISSUED BY
1	CONCRETE DAM	10/15/00	WSP-13
2	CONCRETE DAM	10/15/00	WSP-13
3	CONCRETE DAM	10/15/00	WSP-13
4	CONCRETE DAM	10/15/00	WSP-13
5	CONCRETE DAM	10/15/00	WSP-13
6	CONCRETE DAM	10/15/00	WSP-13
7	CONCRETE DAM	10/15/00	WSP-13
8	CONCRETE DAM	10/15/00	WSP-13
9	CONCRETE DAM	10/15/00	WSP-13
10	CONCRETE DAM	10/15/00	WSP-13

PERMITS - THIS SHEET ONLY

NO.	TYPE	DATE	ISSUED BY
1	CONCRETE DAM	10/15/00	WSP-13
2	CONCRETE DAM	10/15/00	WSP-13
3	CONCRETE DAM	10/15/00	WSP-13
4	CONCRETE DAM	10/15/00	WSP-13
5	CONCRETE DAM	10/15/00	WSP-13
6	CONCRETE DAM	10/15/00	WSP-13
7	CONCRETE DAM	10/15/00	WSP-13
8	CONCRETE DAM	10/15/00	WSP-13
9	CONCRETE DAM	10/15/00	WSP-13
10	CONCRETE DAM	10/15/00	WSP-13

NOTES:  
 1. SEE ARCHITECTURAL, CIVIL AND MECHANICAL DRAWINGS FOR DETAILS.  
 2. SEE ARCHITECTURAL AND CIVIL DRAWINGS FOR DETAILS.  
 3. SEE ARCHITECTURAL AND CIVIL DRAWINGS FOR DETAILS.

WILLIAM A. SCHAEFER  
 LICENSED PROFESSIONAL ENGINEER  
 LICENSE NO. 10000  
 STATE OF WASHINGTON  
 DATE: 7.8.07

58 18  
 MARLE VALLEY TO ISKQUANHOCHART RD.  
 TAYLOR CREEK BRK. 58 18 CROSSING A  
 STREAM PLANNING PLAN  
 WSP-13  
 10/15/00

Washington State  
 Department of Transportation  
 58 18  
 MARLE VALLEY TO ISKQUANHOCHART RD.  
 TAYLOR CREEK BRK. 58 18 CROSSING A  
 STREAM PLANNING PLAN  
 WSP-13  
 10/15/00