



Washington State
Department of Transportation
 Paula Hammond
 Secretary of Transportation

Transportation Building
 310 Maple Park Ave
 P.O. Box 47300
 Olympia, WA 98504-7300

360-705-7000
 TTY: 1-800-833-6388
www.wsdot.wa.gov

March 25, 2009

Mr. Pat Chapman
 Washington State Department of Fish and Wildlife
 Habitat Program
 600 N. Capitol Way
 Olympia, WA 98501-1091

RE: SR 18 Maple Valley to Issaquah-Hobart Road (MP 16.6 to MP 19.3) (Taylor Creek SE 215th Place)
 WDFW HPA Permit **00000F4792-14**

Dear Mr. Chapman:

The Washington State Department of Transportation completed monitoring of the site on July 2, 2008 to determine survival of planted species for compliance with the above listed HPA.

General Site Information	
WDFW HPA Permit Number	00000F4792-14
LLID Number	1220367474091
Restoration Location	Northwest of Maxwell Road and SR 18, in King County.
Construction Date	2006-2007
Monitoring Period	2007-2016
Year of Monitoring	2 of 10
Area of Project Impact	0.52 acre Buffer 125 ft Stream Channel
Type of Restoration	Riparian Revegetation
Area of Restoration	0.35 acre

Site development:

Permit Requirement	2008 Results	Management Activities
80% or greater survival for each planted species	75% survival overall	In 2008, weed control was conducted on 4/16, 6/4, and 9/5; weed control will continue as needed; stakes planted summer 2008, more planned for spring 2009.

Survival of planted native woody species is 75 percent across the entire site. This value does not satisfy the permit requirement (minimum 80 percent survival). Mortality appears to

increase as the distance from the creek increases. *Rosa* species (roses) and fascines appear to be growing vigorously. No evidence of erosion was observed along the stream banks.

Live willow stakes were planted between the fascines and the bank in the summer of 2008. More live stake planting is planned for the spring of 2009.

We welcome your questions or comments. Please contact me at 360-570-6640 or by e-mail at busht@wsdot.wa.gov for questions about this mitigation site.

Sincerely,

Tony Bush
Wetland Assessment and Monitoring Program

FILE NAME	SR 18 - 4000' W. 1/2 SECTION 36, T20N, R10E, S18
DATE	10/26/17 AM
REGISTERED BY	A. KAVYKA
DESIGNED BY	A. KAVYKA
CHECKED BY	B. MULLER
PROJ. ENGR.	B. MULLER
REGIONAL ADM. ENGR.	B. MULLER
REVISION	DATE
REVISION	DATE
REVISION	DATE

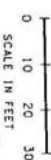
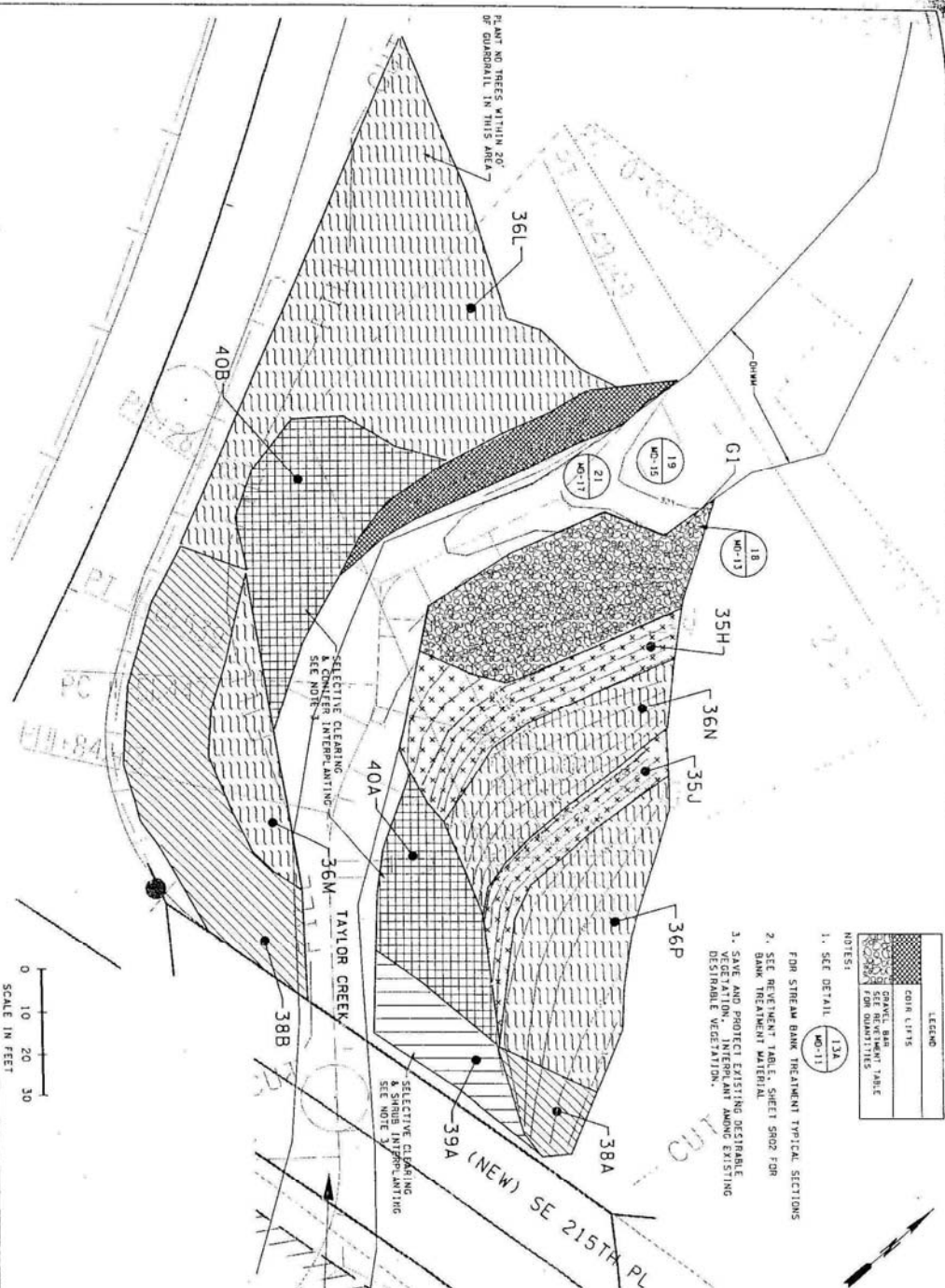

LEGEND	
[Symbol]	COR LINES
[Symbol]	GRAVEL, SAND & SLOPE PROTECTION
[Symbol]	DESIGNATED PLANTING AREAS

- NOTES:
1. SEE DETAIL MO-11
 2. SEE REVISION TABLE, SHEET SPOD FOR BANK TREATMENT MATERIAL
 3. SAVE AND PROTECT EXISTING DESIRABLE VEGETATION. INTERPLANT AMONG EXISTING DESIRABLE VEGETATION.

SYMBOL	TREE	PLANT QUANTITIES - THIS SHEET ONLY	QUANTITY
SR 18	BLACK LOCUST (LBI)	35H 35J	5 3
SR 18	RED ALDER	35H 35J	3 2
SR 18	WESTERN RED CEDAR	35H 35J	4 4
SR 18	RED OSTER DOGWOOD (RND)	35H 35J	1 3
SR 18	SLABBERN	35H 35J	1 3
SR 18	SCOTT'S MILLOW (SMI)	35H 35J	1 3
SR 18	SOIL AMENDMENT (SMT)	35H 35J	1 3
SR 18	COMPOST TYPE 1 (CT1)	35H 35J	4 2
SR 18	BANK ON WOOD CHIP MULCH (BWC)	35H 35J	4 2
SR 18	BRAND BARRIER MIX 3% - 4" D.C.	35H 35J	3 1
SR 18	BRAND BARRIER MIX 3% - 5" D.C.	35H 35J	3 1
SR 18	BRAND BARRIER MIX 3% - 6" D.C.	35H 35J	3 1
SR 18	BRAND BARRIER MIX 3% - 7" D.C.	35H 35J	3 1
SR 18	BRAND BARRIER MIX 3% - 8" D.C.	35H 35J	3 1
SR 18	BRAND BARRIER MIX 3% - 9" D.C.	35H 35J	3 1
SR 18	BRAND BARRIER MIX 3% - 10" D.C.	35H 35J	3 1
SR 18	BRAND BARRIER MIX 3% - 11" D.C.	35H 35J	3 1
SR 18	BRAND BARRIER MIX 3% - 12" D.C.	35H 35J	3 1
SR 18	BRAND BARRIER MIX 3% - 13" D.C.	35H 35J	3 1
SR 18	BRAND BARRIER MIX 3% - 14" D.C.	35H 35J	3 1
SR 18	BRAND BARRIER MIX 3% - 15" D.C.	35H 35J	3 1
SR 18	BRAND BARRIER MIX 3% - 16" D.C.	35H 35J	3 1
SR 18	BRAND BARRIER MIX 3% - 17" D.C.	35H 35J	3 1
SR 18	BRAND BARRIER MIX 3% - 18" D.C.	35H 35J	3 1
SR 18	BRAND BARRIER MIX 3% - 19" D.C.	35H 35J	3 1
SR 18	BRAND BARRIER MIX 3% - 20" D.C.	35H 35J	3 1
SR 18	BRAND BARRIER MIX 3% - 21" D.C.	35H 35J	3 1
SR 18	BRAND BARRIER MIX 3% - 22" D.C.	35H 35J	3 1
SR 18	BRAND BARRIER MIX 3% - 23" D.C.	35H 35J	3 1
SR 18	BRAND BARRIER MIX 3% - 24" D.C.	35H 35J	3 1
SR 18	BRAND BARRIER MIX 3% - 25" D.C.	35H 35J	3 1
SR 18	BRAND BARRIER MIX 3% - 26" D.C.	35H 35J	3 1
SR 18	BRAND BARRIER MIX 3% - 27" D.C.	35H 35J	3 1
SR 18	BRAND BARRIER MIX 3% - 28" D.C.	35H 35J	3 1
SR 18	BRAND BARRIER MIX 3% - 29" D.C.	35H 35J	3 1
SR 18	BRAND BARRIER MIX 3% - 30" D.C.	35H 35J	3 1
SR 18	BRAND BARRIER MIX 3% - 31" D.C.	35H 35J	3 1
SR 18	BRAND BARRIER MIX 3% - 32" D.C.	35H 35J	3 1
SR 18	BRAND BARRIER MIX 3% - 33" D.C.	35H 35J	3 1
SR 18	BRAND BARRIER MIX 3% - 34" D.C.	35H 35J	3 1
SR 18	BRAND BARRIER MIX 3% - 35" D.C.	35H 35J	3 1
SR 18	BRAND BARRIER MIX 3% - 36" D.C.	35H 35J	3 1
SR 18	BRAND BARRIER MIX 3% - 37" D.C.	35H 35J	3 1
SR 18	BRAND BARRIER MIX 3% - 38" D.C.	35H 35J	3 1
SR 18	BRAND BARRIER MIX 3% - 39" D.C.	35H 35J	3 1
SR 18	BRAND BARRIER MIX 3% - 40" D.C.	35H 35J	3 1
SR 18	BRAND BARRIER MIX 3% - 41" D.C.	35H 35J	3 1
SR 18	BRAND BARRIER MIX 3% - 42" D.C.	35H 35J	3 1
SR 18	BRAND BARRIER MIX 3% - 43" D.C.	35H 35J	3 1
SR 18	BRAND BARRIER MIX 3% - 44" D.C.	35H 35J	3 1
SR 18	BRAND BARRIER MIX 3% - 45" D.C.	35H 35J	3 1
SR 18	BRAND BARRIER MIX 3% - 46" D.C.	35H 35J	3 1
SR 18	BRAND BARRIER MIX 3% - 47" D.C.	35H 35J	3 1
SR 18	BRAND BARRIER MIX 3% - 48" D.C.	35H 35J	3 1
SR 18	BRAND BARRIER MIX 3% - 49" D.C.	35H 35J	3 1
SR 18	BRAND BARRIER MIX 3% - 50" D.C.	35H 35J	3 1
SR 18	BRAND BARRIER MIX 3% - 51" D.C.	35H 35J	3 1
SR 18	BRAND BARRIER MIX 3% - 52" D.C.	35H 35J	3 1
SR 18	BRAND BARRIER MIX 3% - 53" D.C.	35H 35J	3 1
SR 18	BRAND BARRIER MIX 3% - 54" D.C.	35H 35J	3 1
SR 18	BRAND BARRIER MIX 3% - 55" D.C.	35H 35J	3 1
SR 18	BRAND BARRIER MIX 3% - 56" D.C.	35H 35J	3 1
SR 18	BRAND BARRIER MIX 3% - 57" D.C.	35H 35J	3 1
SR 18	BRAND BARRIER MIX 3% - 58" D.C.	35H 35J	3 1
SR 18	BRAND BARRIER MIX 3% - 59" D.C.	35H 35J	3 1
SR 18	BRAND BARRIER MIX 3% - 60" D.C.	35H 35J	3 1
SR 18	BRAND BARRIER MIX 3% - 61" D.C.	35H 35J	3 1
SR 18	BRAND BARRIER MIX 3% - 62" D.C.	35H 35J	3 1
SR 18	BRAND BARRIER MIX 3% - 63" D.C.	35H 35J	3 1
SR 18	BRAND BARRIER MIX 3% - 64" D.C.	35H 35J	3 1
SR 18	BRAND BARRIER MIX 3% - 65" D.C.	35H 35J	3 1
SR 18	BRAND BARRIER MIX 3% - 66" D.C.	35H 35J	3 1
SR 18	BRAND BARRIER MIX 3% - 67" D.C.	35H 35J	3 1
SR 18	BRAND BARRIER MIX 3% - 68" D.C.	35H 35J	3 1
SR 18	BRAND BARRIER MIX 3% - 69" D.C.	35H 35J	3 1
SR 18	BRAND BARRIER MIX 3% - 70" D.C.	35H 35J	3 1
SR 18	BRAND BARRIER MIX 3% - 71" D.C.	35H 35J	3 1
SR 18	BRAND BARRIER MIX 3% - 72" D.C.	35H 35J	3 1
SR 18	BRAND BARRIER MIX 3% - 73" D.C.	35H 35J	3 1
SR 18	BRAND BARRIER MIX 3% - 74" D.C.	35H 35J	3 1
SR 18	BRAND BARRIER MIX 3% - 75" D.C.	35H 35J	3 1
SR 18	BRAND BARRIER MIX 3% - 76" D.C.	35H 35J	3 1
SR 18	BRAND BARRIER MIX 3% - 77" D.C.	35H 35J	3 1
SR 18	BRAND BARRIER MIX 3% - 78" D.C.	35H 35J	3 1
SR 18	BRAND BARRIER MIX 3% - 79" D.C.	35H 35J	3 1
SR 18	BRAND BARRIER MIX 3% - 80" D.C.	35H 35J	3 1
SR 18	BRAND BARRIER MIX 3% - 81" D.C.	35H 35J	3 1
SR 18	BRAND BARRIER MIX 3% - 82" D.C.	35H 35J	3 1
SR 18	BRAND BARRIER MIX 3% - 83" D.C.	35H 35J	3 1
SR 18	BRAND BARRIER MIX 3% - 84" D.C.	35H 35J	3 1
SR 18	BRAND BARRIER MIX 3% - 85" D.C.	35H 35J	3 1
SR 18	BRAND BARRIER MIX 3% - 86" D.C.	35H 35J	3 1
SR 18	BRAND BARRIER MIX 3% - 87" D.C.	35H 35J	3 1
SR 18	BRAND BARRIER MIX 3% - 88" D.C.	35H 35J	3 1
SR 18	BRAND BARRIER MIX 3% - 89" D.C.	35H 35J	3 1
SR 18	BRAND BARRIER MIX 3% - 90" D.C.	35H 35J	3 1
SR 18	BRAND BARRIER MIX 3% - 91" D.C.	35H 35J	3 1
SR 18	BRAND BARRIER MIX 3% - 92" D.C.	35H 35J	3 1
SR 18	BRAND BARRIER MIX 3% - 93" D.C.	35H 35J	3 1
SR 18	BRAND BARRIER MIX 3% - 94" D.C.	35H 35J	3 1
SR 18	BRAND BARRIER MIX 3% - 95" D.C.	35H 35J	3 1
SR 18	BRAND BARRIER MIX 3% - 96" D.C.	35H 35J	3 1
SR 18	BRAND BARRIER MIX 3% - 97" D.C.	35H 35J	3 1
SR 18	BRAND BARRIER MIX 3% - 98" D.C.	35H 35J	3 1
SR 18	BRAND BARRIER MIX 3% - 99" D.C.	35H 35J	3 1
SR 18	BRAND BARRIER MIX 3% - 100" D.C.	35H 35J	3 1

Washington State
Department of Transportation

SR 18
MAPLE VALLEY TO ISSAQUAHOBART RD.
SE 215TH PLACE

STREAM PLANTING PLAN

STATE OF WASHINGTON
REGISTERED LANDSCAPE ARCHITECT

Sally A. Anderson
SALLY A. ANDERSON
CERTIFICATE NO. 372
DATE: 7-2-03