



March 25, 2011

Washington State Department of Fish and Wildlife
 Habitat Program
 600 N. Capitol Way
 Olympia, WA 98501-1091

RE: SR 9 Schloman Road to 256th St NE & 268th St NE Intersection Mitigation Site
WDFW HPA Permit 103999-6

Dear Interested Parties:

The Washington State Department of Transportation completed monitoring of the site on August 23rd, 2010 to determine survival of planted species for compliance with the above-listed HPA. This year-2 report is being written to assess only the riparian plantings, not the entire wetland mitigation site.

General Site Information		
USACE NWP 23 Number	200500952	
WIN Number	A00930H	
Mitigation Location	North of Arlington, off of SR 9 in Snohomish County	
LLID Number	1221371482145	
Construction Date	2007-2008	
Monitoring Period	2009-2018	
Year of Monitoring	2 of 10	
Type of Project Impact	Wetland	Wetland and Stream Buffer
Area of Project Impact	1.47 acres	3.48 acres
Type of Mitigation	Wetland Establishment	Wetland and Stream Buffer Enhancement
Area of Mitigation	3.12 acres	3.84 acres

Site development:

Permit Requirement	2010 Results	Management Activities
80% or greater survival for each planted species in the riparian area	97% survival overall	Ongoing weed control, additional plantings installed fall 2010.

Survival of planted woody species at each of the five riparian planting areas combined is 97 percent. This is above the 80 percent threshold, meeting the permit requirement for Year-2. Survival is based on numbers established in the field, comparing the ratio of visibly live to total native woody species. Woody plantings generally appear healthy and vigorous. The plantings at Kackman Creek near the roadside appear to have been mowed during road maintenance and the majority of the mortality occurred at this location. Survival at this location was 63 percent and this area could benefit from minor re-planting.

We welcome your questions or comments. Please contact me at 360/570-6640 or by e-mail at busht@wsdot.wa.gov for questions about these mitigation sites.

Sincerely,

Tony Bush
Wetland Assessment and Monitoring Program

HPA Plantings On-Site -

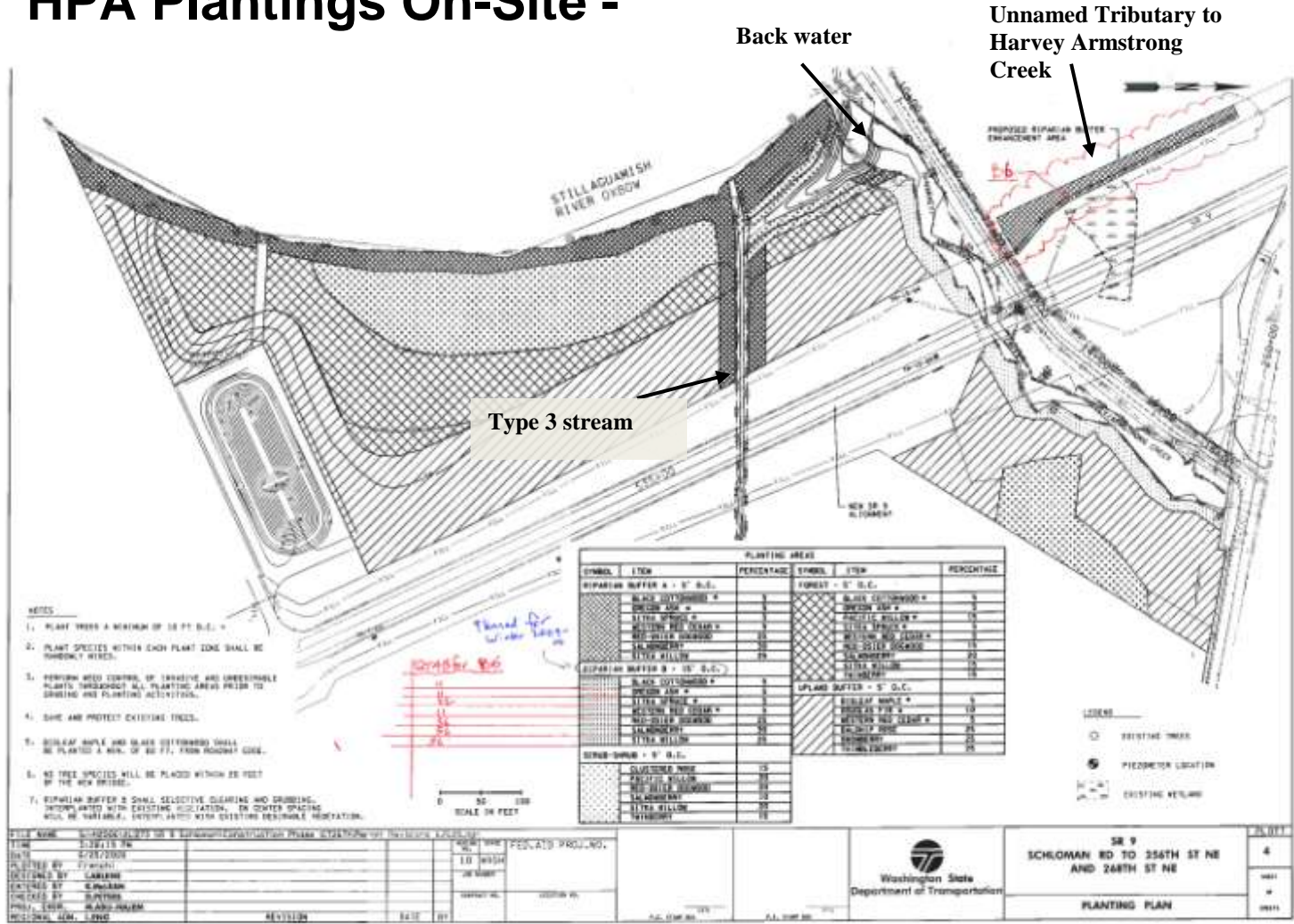

HPA Plantings offsite -

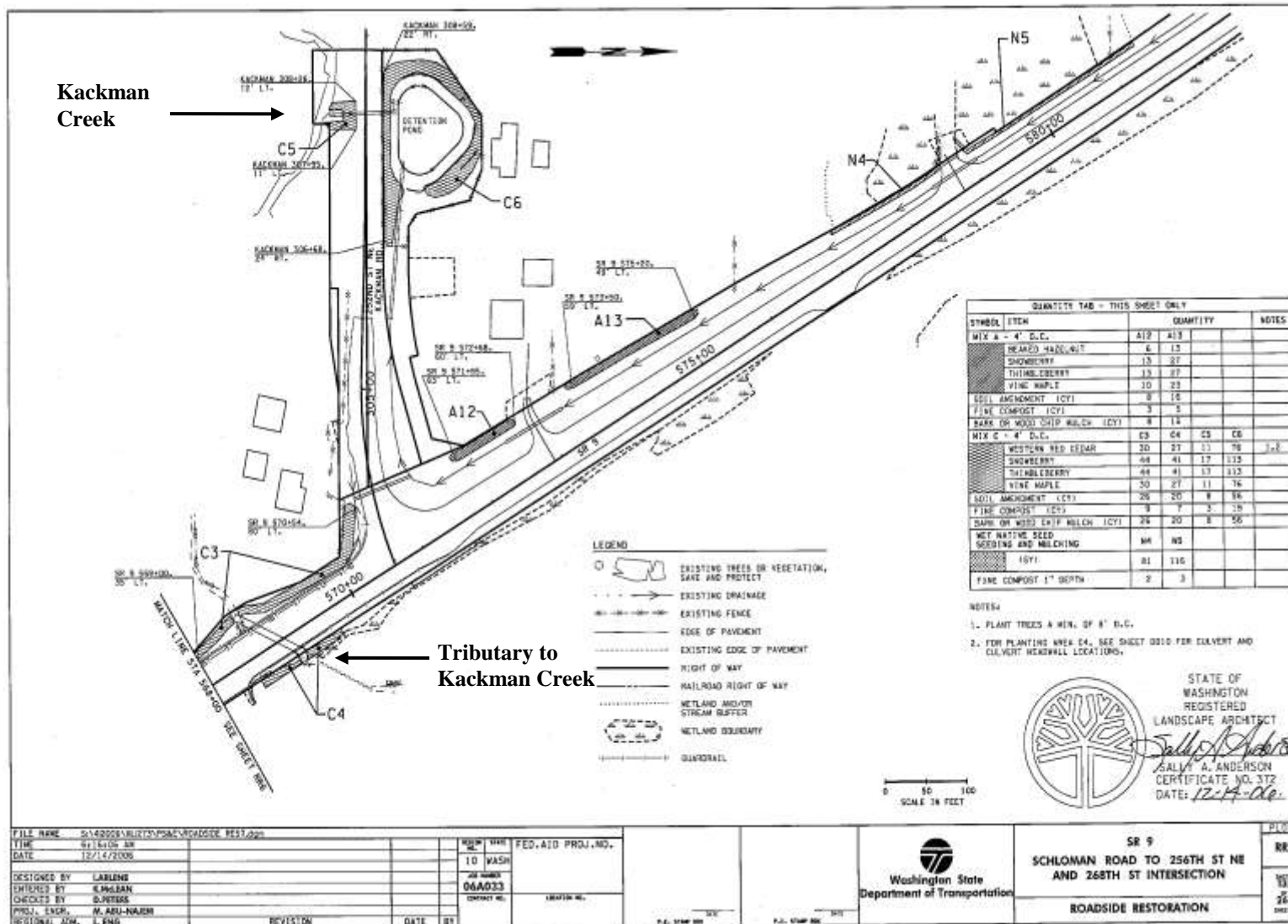

Individual Survival Results by HPA Planting Area –

	Total (Alive + Dead)	Alive	Survival
Backwater	127	125	98%
Kackman creek	27	17	63%
Trib to kackman	98	98	100%
Type 3 stream	221	211	95%
Unnamed trib	340	338	99%
totals	813	789	97%