

PLOT DATE: 30-NOV-2007

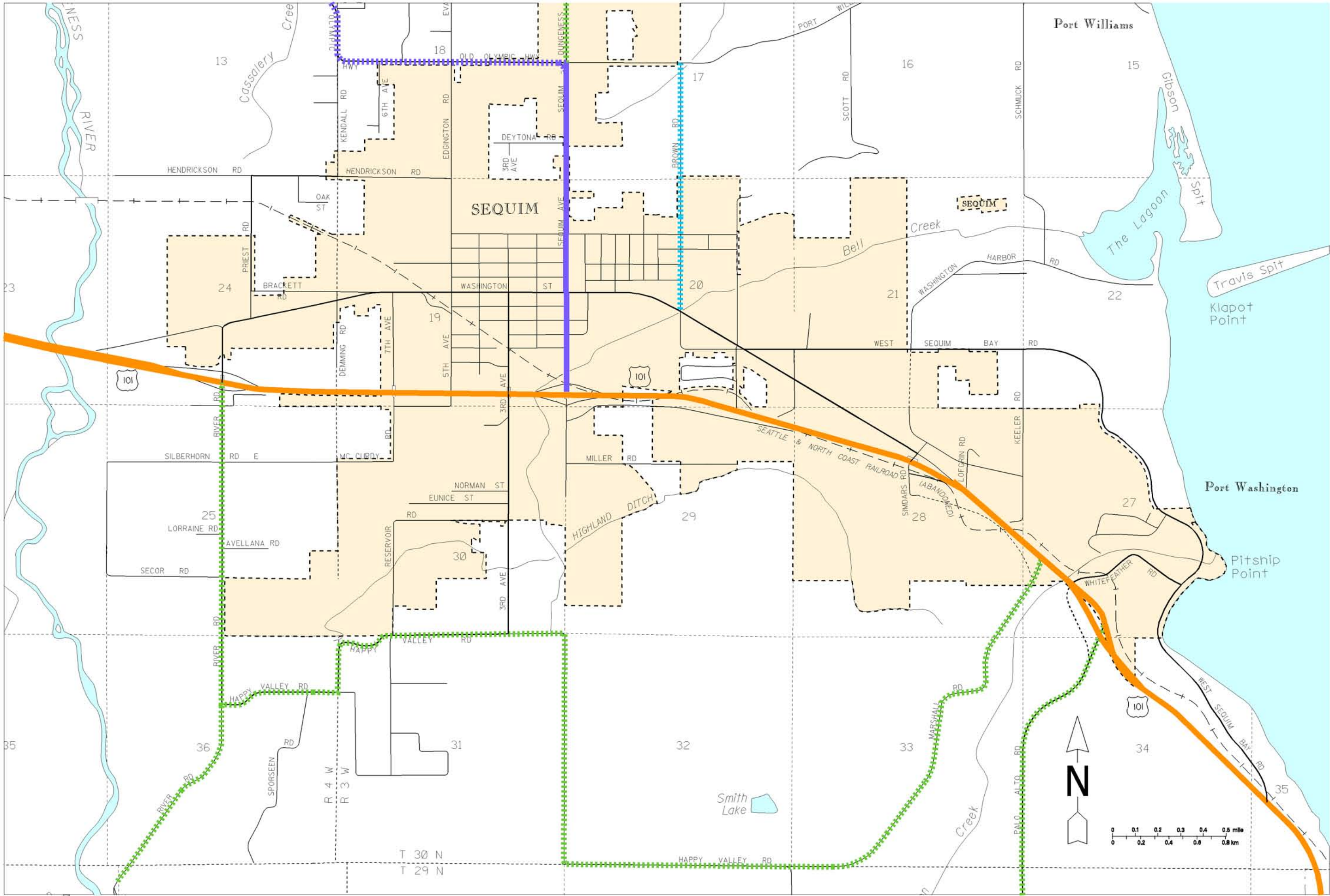

**Freight and Goods Transportation System**

**Roadways 2007**

WASHINGTON STATE DEPARTMENT OF TRANSPORTATION

TONNAGE CLASS  
T1 - T5  
ANNUAL TONS  
(in thousands)

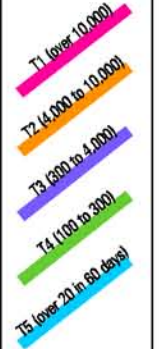

No Seasonal Weight Restrictions  
Seasonal Weight Restrictions



SEQUIM  
CLALLAM COUNTY

