

CASE 22 C_
(SEE NOTE 4)

CASE 22 D_
(SEE NOTE 4)

CASE 22 A_
(SEE NOTE 4)

CASE 22 B_
(SEE NOTE 4)

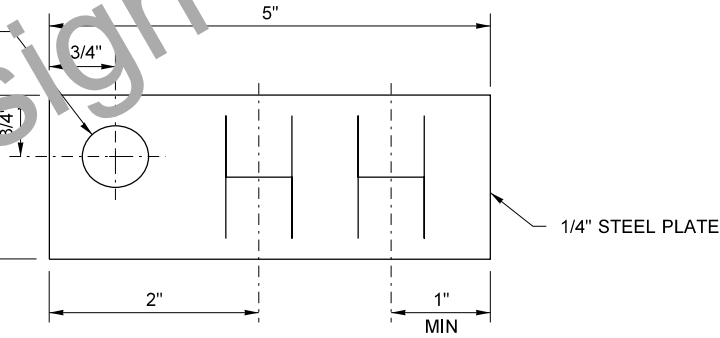

IDENTIFICATION PLATE DETAIL
(SEE NOTE 6)

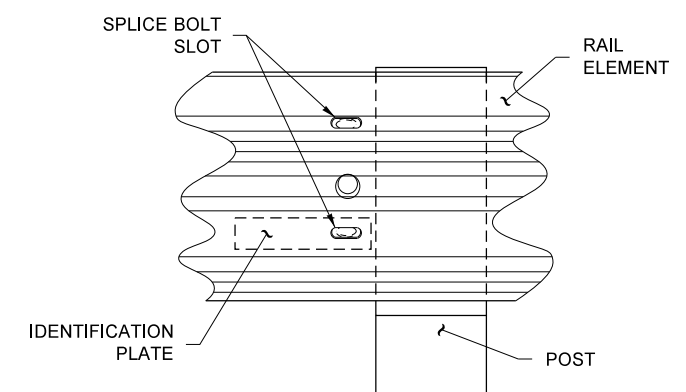

IDENTIFICATION PLATE MOUNTING DETAIL
(SEE NOTE 7)

NOTES

- SEE CONTRACT FOR TRANSITION AND CONNECTION TYPE.
- THE SLOPE FROM THE EDGE OF THE SHOULDER INTO THE FACE OF THE GUARDRAIL SHOULD NOT BE STEEPER THAN 10H: 1 V.
- GUARDRAIL INSTALLATION SHALL BE BEAM GUARDRAIL TYPE 1 WITH STANDARD POST AND BLOCK.
- FIRST LETTER OF CASE DESIGNATION INDICATES END TREATMENT ON MAIN ROAD. FOR INSTANCE, A TERMINAL ON THE SIDE ROAD AND A BRIDGE CONNECTION ON THE MAIN ROAD WOULD BE CASE 22 BC.
- FOR TERMINAL TYPE AND DETAILS SEE CONTRACT AND APPLICABLE PLAN(S).
- RADIUS DIMENSIONS SHALL BE ETCHED INTO PLATE REPLACING THE LETTERS "HH" SHOWN ON THE IDENTIFICATION PLATE DETAIL. DIGITS SHALL BE 1" MIN. HEIGHT AND "MAXIMUM WIDTH. PLATE SHALL BE GALVANIZED AFTER ETCHING.
- THE GUARDRAIL IDENTIFICATION PLATE SHALL BE MOUNTED AT THE LOWER SPLICE BOLT ON THE BACK SIDE OF THE RAIL ELEMENT AT THE PC OF THE GUARDRAIL RADIUS.

**TYPE 1 GUARDRAIL STRONG POST INTERSECTION DESIGN
(CASES 22AC, 22AD, 22BC & 22BD)**

FILE NAME: S:\Design R P & S\4-Standards\2-Plan Sheet Library\02-PSL Work in Progress\C series conversion\TB-c2p\TB-c2p.dgn		REGION NO. STATE		FED.AID PROJ.NO.		DATE		DATE		Plot 1
TIME: 2:50:21 PM		10	WASH			P.E. STAMP BOX		P.E. STAMP BOX		PLAN REF NO
DATE: 8/1/2018		JOB NUMBER								TB -C2p
PLOTTED BY: liddelf		CONTRACT NO.		LOCATION NO.						SHEET
DESIGNED BY:										1
ENTERED BY:										OF
CHECKED BY:										1
PROJ. ENGR.:										SHEETS
REGIONAL ADM.:	REVISION	DATE	BY							1

